

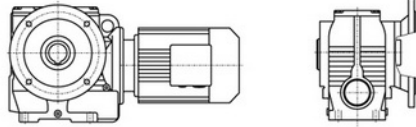

S系列减速机有以下设计方案：  
S series gear units are available in the following designs:

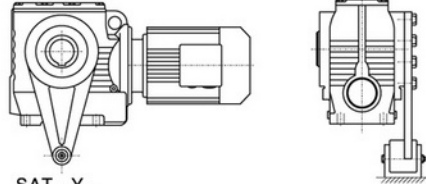

SAF...Y..  
法兰空心轴安装斜齿-蜗轮蜗杆减速机  
Flange-mounted helical-worm gear units with hollow shaft



SAT...Y..  
带防转臂空心轴安装斜齿-蜗轮蜗杆减速机  
Torque-arm-mounted helical-worm gear units with hollow shaft

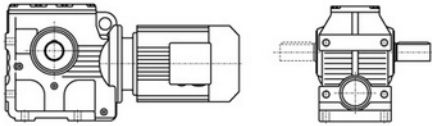

S..Y..  
底脚轴伸式安装斜齿-蜗轮蜗杆减速机  
Foot-mounted helical-worm gear units with solid shaft

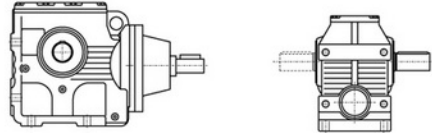

S(SF, SA, SAF, SAZ) S...  
轴输入的斜齿-蜗轮蜗杆减速机  
Shaft input helical-worm gear units

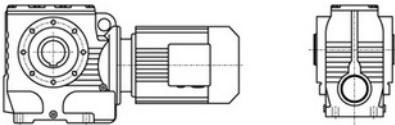

SA...Y..  
空心轴安装斜齿-蜗轮蜗杆减速机  
Helical-worm gear units with hollow shaft

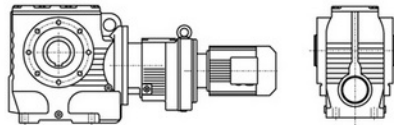

SA (S, SF, SAF, SAZ) ...R...Y..  
组合式斜齿-蜗轮蜗杆减速机  
Combinatorial helical-worm gear units

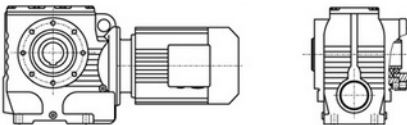

SAZ...Y..  
小法兰空心轴安装斜齿-蜗轮蜗杆减速机  
Short-flange mounted helical-worm gear units with hollow shaft

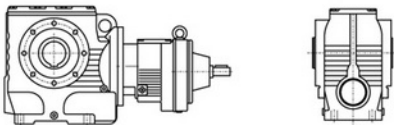

SA (S, SF, SAF, SAZ) S...R...  
轴输入的组合式斜齿-蜗轮蜗杆减速机  
Shaft input combinatorial helical-worm gear units

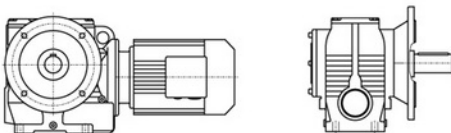

SF...Y..  
法兰轴伸式安装斜齿-蜗轮蜗杆减速机  
Flange-mounted helical-worm gear units with solid shaft



SA(S, SF, SAF, SAZ) ...Y..  
电机用户自配或配特殊电机时需加联接法兰  
When equipping the user's motor or the special one, the flange is required to be connected



型号与标记:

Type Designations:

S AF37-Y 0.55-4P-12.08-M1-270°-A-Φ25	S AF37-Y 0.55-4P-12.08-M1-270°-A-Φ25
减速机类型 结构形式 规格 电机代号 电机功率、极数 传动比 安装形式 电机接线盒位置 输出轴或法兰方向 输出轴孔径	Gear units type Structure Size Motor code Motor power, pole Ratio Mounting position Position of the motor thermal box Position of output shaft or flange Output shaft aperture
<b>减速机类型:</b> 斜齿-蜗轮蜗杆减速机	<b>Gear units type:</b> Helical-worm gear units
<b>结构形式:</b> 普通轴伸式 (省略) 轴装式 A 轴伸法兰式 F 轴装法兰式 AF 轴装小法兰式 AZ 轴装带防转臂 AT 普通轴伸式, 轴输入 S 普通轴装式, 轴输入 AS 轴伸法兰式, 轴输入 FS 轴装法兰式, 轴输入 AFS	<b>Structure:</b> Foot-mounted solid shaft output (-) Hollow shaft output A Flange-mounted solid shaft output F Flange-mounted hollow shaft output AF Short-flange-mounted hollow shaft output AZ Torque-arm-mounted hollow shaft output AT Foot-mounted solid shaft output, shaft input S Hollow shaft output, shaft input AS Flange-mounted solid shaft output, shaft input FS Flange-mounted hollow shaft output, shaft input AFS
<b>规格:</b> (见选型参数表)	<b>Size:</b> (see selection table)
<b>电机代号:</b> 普通 (更新) Y(Y2) 防爆 B 直流 Z 制动 YEJ 多速 D 变频 YVP 电磁调速 YCT 冶金起重 R 变频制动 YVPJ 辊道 G	<b>Motor code:</b> Ordinary (renew) Y(Y2) Flame-proof B Direct current Z Brake YEJ Multi-speed D Variable frequency YVP Electromagnetism speed modulation YCT Hoisting in metallurgy R Variable frequency and brake YVPJ Roller tables G
<b>电机功率、极数:</b> (见选型参数表)	<b>Motor power, pole:</b> (see selection table)
<b>传动比:</b> (见选型参数表)	<b>Ratio:</b> (see selection table)
<b>安装形式:</b> M1、M2、M3、M4、M5、M6 (见第67页)	<b>Mounting position:</b> M1、M2、M3、M4、M5、M6 (see page 67)
<b>电机接线盒位置:</b> 0°、90°、180°、270° (见第67页)	<b>Position of the motor thermal box:</b> 0°、90°、180°、270° (see page 67)
<b>输出轴或法兰方向:</b> 从电机尾部看左边 A 从电机尾部看右边 B (见安装形式) 从电机尾部看左右边为 A+B	<b>Position of output shaft or flange:</b> viewing on motor end: left side -A, right side -B, both sides -A+B (see mounting position)
<b>输出轴孔径:</b> (见安装尺寸图)带实心轴输出时省略	<b>Output shaft aperture:</b> (see the chart of mounting dimension) It will be omitted when solid output shaft



安装形式  
Mounting position

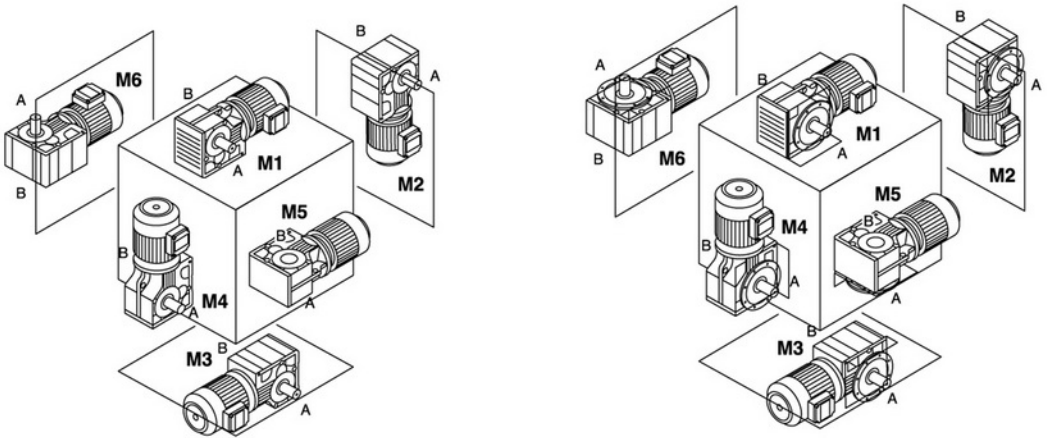

电机接线盒位置  
Position of the motor thermal box

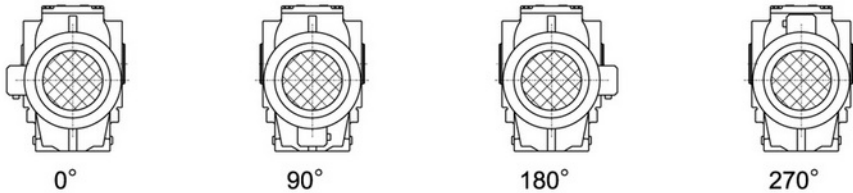

输入功率及许用转矩  
Input power rating and permissible torque

规格 Size	37	47	57	67	77	87	97
结构形式 Structure	S SA SF SAF SAT SAZ						
输入功率(kW) Input power rating	0.18~0.75	0.18~1.5	0.18~3	0.25~5.5	0.55~7.5	0.75~15	1.5~22
传动比 Ratio	10.27~165.71	11.46~244.74	10.78~196.21	11.55~227.20	9.96~241.09	11.83~223.26	12.75~230.48
许用转矩(N.m) Permissible torque	90	170	300	520	1270	2280	4000



## 减速机重量

### Gear unit weight

规格 Size	37	47	57	67	77	87	97
重量 (kg) Weight	7	10	14	26	50	100	170

所注重量为平均值, 仅供参考

The weights are mean values, only for reference.

## 润滑油量表

### Lubrication table

S...:

规格 Size	润滑油量 (升)			Fill quantity in liters		
	M1	M2	M3 <sup>1)</sup>	M4	M5	M6
S37	0.25	0.4	0.5	0.6	0.4	0.4
S47	0.35	0.8	0.7	1.1	0.8	0.8
S57	0.5	1.2	1	1.5	1.3	1.3
S67	1	2.0	2.2/3.1	3.2	2.6	2.6
S77	1.9	4.2	3.7/5.4	6	4.4	4.4
S87	3.3	8.1	6.9/10.4	12	8.4	8.4
S97	6.8	15	13.4/18	22.5	17	17

SF...:

规格 Size	润滑油量 (升)			Fill quantity in liters		
	M1	M2	M3 <sup>1)</sup>	M4	M5	M6
SF37	0.25	0.4	0.5	0.6	0.4	0.4
SF47	0.4	0.9	0.9	1.2	1.0	1.0
SF57	0.5	1.2	1	1.6	1.4	1.4
SF67	1	2.2	2.3/3	3.2	2.7	2.7
SF77	1.9	4.1	3.9/5.8	6.5	4.9	4.9
SF87	3.8	8	7.1/10.1	12	9.1	9.1
SF97	7.4	15	13.8/18.8	23.6	18	18

SA..., SAF..., SAZ...:

规格 Size	润滑油量 (升)			Fill quantity in liters		
	M1	M2	M3 <sup>1)</sup>	M4	M5	M6
S..37	0.25	0.4	0.5	0.6	0.4	0.4
S..47	0.4	0.8	0.7	1.1	0.8	0.8
S..57	0.5	1.1	1	1.6	1.2	1.2
S..67	1	2.0	1.8/2.6	2.9	2.5	2.5
S..77	1.8	3.9	3.6/5	5.9	4.5	4.5
S..87	3.8	7.4	6/8.7	11.2	8	8
S..97	7	14	11.4/16	21	15.7	15.7

注: 1) 表示减速机为组合型时低速级所加油量为大值。

Notes: 1) The large gear unit of multi-stage gear units must be filled with the larger oil volume.



输出转速 Output speed r/min	输出扭矩 Output torque Nm	传动比 Ratio i	使用系数 Service factor f <sub>s</sub>	机型号 Type Type	极数 Pole p	输出转速 Output speed r/min	输出扭矩 Output torque Nm	传动比 Ratio i	使用系数 Service factor f <sub>s</sub>	机型号 Type Type	极数 Pole p
<b>0.18kW</b>						<b>0.18kW</b>					
0.30	2579	4606	0.83			9.5	109	146.84	1.47		
0.36	2563	3872	0.84			10	102	137.25	1.57		
0.40	2515	3475	0.85	S 87R57	4	12	88	118.64	1.82	S 47	4
0.48	2394	2905	0.90	SF 87R57	4	14	75	100.80	2.14	SF 47	4
0.54	2239	2586	0.96	SA 87R57	4	15	67	90.00	2.40	SA 47	4
0.60	2021	2335	1.06	SAF87R57	4	18	57	76.88	2.80	SAF47	4
0.68	1778	2054	1.21			19	53	72.00	2.99		
0.76	1579	1824	1.36			23	45	60.65	3.56		
0.85	1412	1631	1.52								
0.99	1215	1404	0.98			9.1	113	152.00	0.80		
1.1	1078	1245	1.11			11	96	129.41	0.89		
1.3	952	1100	1.25	S 77R37	4	12	83	111.58	1.03		
1.5	826	954	1.45	SF 77R37	4	13	77	104.00	1.10		
1.7	725	837	1.65	SA 77R37	4	15	67	90.91	1.26		
1.9	618	714	1.93	SAF77R37	4	16	63	85.22	1.34		
2.2	551	637	2.2			18	56	75.20	1.52		
2.4	497	574	2.4			21	49	66.67	1.72		
						25	45	56.67	1.89		
						27	42	52.00	2.02	S 37	4
1.7	600	809	0.81			31	39	45.45	2.16	SF 37	4
2.0	532	712	0.92	S 67R37	4	33	37	42.61	2.30	SA 37	4
2.3	528	615	0.93	SF 67R37	4	37	33	37.60	2.61	SAF37	4
2.6	470	543	1.04	SA 67R37	4	42	29	33.33	2.95		
3.0	406	469	1.20	SAF67R37	4	49	25	28.33	3.47		
3.3	367	424	1.33			59	23	23.46	3.66		
3.8	316	365	1.55			74	19	18.85	4.56		
						84	16	16.48	5.21		
						90	15	15.45	5.56		
						102	13	13.63	6.30		
						115	12	12.08	7.11		
						135	10	10.27	8.37		
						<b>0.25kW</b>					
						0.48	2495	2905	0.86		
						0.54	2470	2586	0.87	S 87R57	4
						0.60	2406	2335	0.89	SF 87R57	4
						0.68	2221	2054	0.96	SA 87R57	4
						0.76	2193	1824	0.98	SAF87R57	4
						0.85	1961	1631	1.09		
						1.5	1118	930	1.92		
						1.5	1147	954	1.04		
						1.7	1006	837	1.19	S 77R37	4
						1.9	858	714	1.39	SF 77R37	4
						2.2	766	637	1.56	SA 77R37	4
						2.4	690	574	1.73	SAF77R37	4
						2.8	600	499	1.99		
						2.6	564	543	0.87		
						3.0	560	469	0.87	S 67R37	4
						3.3	510	424	0.96	SF 67R37	4
						3.8	439	365	1.11	SA 67R37	4
						4.4	384	319	1.27	SAF67R37	4
						4.9	338	281	1.45		
						4.7	353	294	0.80		
						5.2	323	269	0.87	S 57R17	4
						6.1	275	229	1.02	SF 57R17	4
						6.8	245	204	1.15	SA 57R17	4
						7.4	225	187	1.25	SAF57R17	4
						8.4	198	165	1.42		
						11	158	131	1.79		
						2.8	505	227.20	0.97	S 67	8
						3.1	456	205.11	1.07	SF 67	8
						3.6	401	180.46	1.22	SA 67	8
						3.8	378	170.40	1.29	SAF67	8
						4.5	320	144.00	1.53		

S



选型参数表  
Selection Table

输出转速	输出扭矩	传动比	使用系数	机型号	极数	输出转速	输出扭矩	传动比	使用系数	机型号	极数
Output speed	Output torque	Ratio	Service factor	Type	Pole	Output speed	Output torque	Ratio	Service factor	Type	Pole
r/min	Nm	i	f <sub>s</sub>	Type	p	r/min	Nm	i	f <sub>s</sub>	Type	p
<b>0.25kW</b>						<b>0.37kW</b>					
3.7	383	227.20	1.28			0.68	2611	2054	0.82	S 87R57	4
4.1	346	205.11	1.41	S 67	6	0.76	2488	1824	0.86	SF 87R57	4
4.7	304	180.46	1.61	SF 67	6	0.85	2318	1631	0.92	SA 87R57	4
5.0	287	170.40	1.70	SA 67	6	1.5	1655	930	1.29	SAF87R57	4
5.9	243	144.00	2.01	SAF67	6	1.7	1479	831	1.45		
6.1	234	227.20	2.09			1.9	1271	714	0.94		
6.8	211	205.11	2.31			2.2	1134	637	1.05	S 77R37	4
7.7	186	180.46	2.63	S 67	4	2.4	1021	574	1.17	SF 77R37	4
8.2	176	170.40	2.78	SF 67	4	2.8	888	499	1.34	SA 77R37	4
9.7	148	144.00	3.30	SA 67	4	3.2	779	438	1.53	SAF77R37	4
11	134	130.00	3.65	SAF67	4	3.6	692	389	1.72		
12	118	114.38	4.15			3.8	557	365	0.88	S 67R37	4
13	111	108.00	4.39			4.4	568	319	0.92	SF 67R37	4
4.3	331	196.21	0.85	S 57	6	4.9	500	281	0.98	SA 67R37	4
4.7	304	180.40	0.93	SF 57	6	5.7	438	246	1.12	SAF67R37	4
5.5	260	154.35	1.08	SA 57	6					S 87	8
6.4	225	133.79	1.25	SAF57	6	3.0	702	222.00	3.03	SF 87	8
6.8	211	125.05	1.34			3.4	627	198.00	3.42	SA 87	8
						4.0	527	166.43	4.07	SAF87	8
7.1	202	196.21	1.39			2.8	763	241.09	1.57	S 77	8
7.7	186	180.40	1.52			3.3	652	206.04	1.83	SF 77	8
9.0	159	154.35	1.77	S 57	4	3.5	598	188.89	2.00	SA 77	8
10	138	133.79	2.05	SF 57	4	4.0	524	165.75	2.28	SAF77	8
11	129	125.05	2.19	SA 57	4	4.3	497	157.08	2.40		
13	111	108.09	2.53	SAF57	4					S 67	6
15	95	91.84	2.98			3.9	544	227.20	0.90	SF 67	6
17	85	82.00	3.34			4.3	491	205.11	1.00	SA 67	6
7.0	204	197.73	0.81			4.9	432	180.46	1.13	SAF67	6
8.3	173	168.00	0.92			5.2	408	170.40	1.20		
9.3	155	150.00	1.04			6.1	345	144.00	1.42		
9.5	151	146.84	1.06							S 67	4
10	141	137.25	1.13			6.1	347	227.20	1.41	SF 67	4
12	122	118.64	1.31	S 47	4	6.8	313	205.11	1.56	S 67	4
14	104	100.80	1.54	SF 47	4	7.7	275	180.46	1.78	SF 67	4
15	93	90.00	1.73	SA 47	4	8.2	260	170.40	1.88	SA 67	4
18	79	76.88	2.02	SAF47	4	9.7	220	144.00	2.23	SAF67	4
19	74	72.00	2.16			11	198	130.00	2.47		
23	71	60.65	2.24			12	174	114.38	2.80		
24	63	59.32	2.56							S 57	6
28	61	50.40	2.64			5.7	370	154.35	0.81	SF 57	6
31	54	45.00	2.96			6.6	321	133.79	0.88	SA 57	6
13	107	104.00	0.81			7.1	300	125.05	0.94	SAF57	6
15	94	90.91	0.91			8.2	259	108.09	1.09		
16	88	85.22	0.97			9.6	220	91.84	1.28		
18	77	75.20	1.10			10.8	196	82.00	1.44		
21	69	66.67	1.24							S 57	4
25	63	56.67	1.36			7.1	299	196.21	0.94	SF 57	4
27	58	52.00	1.46			7.7	275	180.40	1.02	SA 57	4
31	55	45.45	1.56			9.0	235	154.35	1.20	SAF57	4
33	51	42.61	1.66			10	204	133.79	1.38		
37	45	37.60	1.88	S 37	4	11	191	125.05	1.48	S 57	4
42	40	33.33	2.12	SF 37	4	13	165	108.09	1.71	SF 57	4
49	34	28.33	2.50	SA 37	4	15	140	91.84	2.01	SA 57	4
59	32	23.46	2.64	SAF37	4	17	125	82.00	2.25		
74	26	18.85	3.28			20	119	70.04	2.64		
84	23	16.48	3.75			21	111	66.89	2.37		
90	21	15.45	4.00			22	107	62.53	2.53		
102	19	13.63	4.54							S 47	4
115	17	12.08	5.12			10	209	137.25	0.80	SF 47	4
135	14	10.27	6.02			12	181	118.64	0.88	SA 47	4
						14	154	100.80	1.04	SAF47	4
						15	137	90.00	1.17		
						18	117	76.88	1.36		



输出转速 Output speed r/min	输出扭矩 Output torque Nm	传动比 Ratio i	使用系数 Service factor f <sub>s</sub>	机型号 Type Type	极数 Pole p	输出转速 Output speed r/min	输出扭矩 Output torque Nm	传动比 Ratio i	使用系数 Service factor f <sub>s</sub>	机型号 Type Type	极数 Pole p
<b>0.37kW</b>						<b>0.55kW</b>					
19	110	72.00	1.46			3.7	859	241.09	1.39		
23	106	60.65	1.52			4.3	734	206.04	1.63	S 77	6
24	93	59.32	1.73			4.7	673	188.89	1.78	SF 77	6
28	90	50.40	1.78			5.3	590	165.75	2.02	SA 77	6
31	80	45.00	2.00	S 47	4	5.6	559	157.08	2.13	SAF77	6
36	68	38.44	2.34	SF 47	4						
39	64	36.00	2.50	SA 47	4	5.8	547	241.09	2.18	S 77	4
46	54	30.33	2.96	SAF47	4	6.7	467	206.04	2.56	SF 77	4
50	56	27.74	2.84			7.4	428	188.89	2.79	SA 77	4
54	53	25.93	3.03							SAF77	4
62	46	22.41	3.51			6.1	515	227.20	0.95		
73	39	19.04	4.13			6.8	465	205.11	1.05		
82	35	17.00	4.63			7.7	409	180.46	1.20		
						8.2	386	170.40	1.27		
21	102	66.67	0.84			9.7	326	144.00	1.50	S 67	4
25	93	56.67	0.92			11	295	130.00	1.66	SF 67	4
27	86	52.00	0.98			12	259	114.38	1.89	SA 67	4
31	81	45.45	1.05			13	245	108.00	2.00	SAF67	4
33	76	42.61	1.12			15	208	91.96	2.35		
37	67	37.60	1.27	S 37	4	17	189	83.57	2.58		
42	59	33.33	1.43	SF 37	4	19	172	72.39	2.98		
49	50	28.33	1.69	SA 37	4	21	164	65.00	2.84		
59	48	23.46	1.78	SAF37	4						
74	38	18.85	2.22			9.6	327	91.84	0.86		
84	34	16.48	2.54			11	292	82.00	0.97		
90	31	15.45	2.71			12	251	70.40	1.01	S 57	6
102	28	13.63	3.07			13	278	66.89	1.12	SF 57	6
115	25	12.08	3.46			14	260	62.53	1.09	SA 57	6
135	21	10.27	4.07			16	225	54.05	1.26	SAF57	6
						19	191	45.92	1.48		
						22	170	41.00	1.66		
						25	146	35.20	1.93		
<b>0.55kW</b>						<b>0.55kW</b>					
1.0	2517	1332	0.85			9.0	350	154.35	0.81		
1.2	2475	1191	0.87			10	303	133.79	0.93		
1.3	2460	1032	0.87	S 87R57	4	11	284	125.05	0.99		
1.5	2340	930	0.92	SF 87R57	4	13	245	108.09	1.15		
1.7	2198	831	0.97	SA 87R57	4	15	208	91.84	1.35		
1.9	1902	719	1.13	SAF87R57	4	17	186	82.00	1.52		
2.2	1651	624	1.30			20	177	70.40	1.59		
2.5	1476	558	1.45			21	165	66.89	1.70	S 57	4
3.2	1151	435	1.86			22	160	62.53	1.77	SF 57	4
						26	143	54.05	1.97	SA 57	4
2.8	1320	499	0.90			30	121	45.92	2.32	SAF57	4
3.2	1159	438	1.03	S 77R37	4	34	108	41.00	2.60		
3.6	1029	389	1.16	SF 77R37	4	40	93	35.02	3.04		
4.3	865	327	1.38	SA 77R37	4	42	91	32.80	3.10		
4.8	764	289	1.56	SAF77R37	4	46	87	30.12	3.25		
5.6	661	250	1.81			53	79	26.11	3.57		
						57	74	24.40	3.82		
5.7	558	246	0.84	S 67R37	4	66	64	21.09	4.42		
6.3	585	221	0.88	SF 67R37	4						
7.0	524	198	0.93	SA 67R37	4	18	174	76.88	0.92		
8.3	444	168	1.10	SAF67R37	4	19	163	72.00	0.98		
						23	157	60.65	1.02		
3.0	1044	222.00	2.05	S 87	8	25	138	59.32	1.16		
3.4	931	198.00	2.30	SF 87	8	28	133	50.40	1.20		
4.0	783	166.43	2.74	SA 87	8	31	119	45.00	1.34		
				SAF87	8	36	102	38.44	1.57	S 47	4
						39	95	36.00	1.68	SF 47	4
4.0	791	222.00	2.71	S 87	6	46	80	30.33	1.91	SA 47	4
4.5	705	198.00	3.04	SF 87	6	50	84	27.74	1.99	SAF47	4
5.3	593	166.43	3.62	SA 87	6	54	78	25.93	2.04		
				SAF87	6	62	68	22.41	2.36		
						73	58	19.04	2.78		
3.3	969	206.04	1.23	S 77	8	82	51	17.00	3.11		
3.5	888	188.89	1.34	SF 77	8	96	44	14.52	3.65		
4.0	780	165.75	1.53	SA 77	8	102	41	13.60	3.89		
4.3	739	157.08	1.62	SAF77	8	121	35	11.46	4.62		

S



**选型参数表**  
Selection Table

输出转速	输出扭矩	传动比	使用系数	机型号	极数	输出转速	输出扭矩	传动比	使用系数	机型号	极数		
Output speed	Output torque	Ratio	Service factor	Type	Pole	Output speed	Output torque	Ratio	Service factor	Type	Pole		
r/min	Nm	i	f <sub>s</sub>	Type	p	r/min	Nm	i	f <sub>s</sub>	Type	p		
<b>0.55kW</b>						<b>0.75kW</b>							
42	88	33.33	0.96			6.8	634	205.11	0.80				
49	75	28.33	1.13			7.7	558	180.46	0.88				
59	71	23.46	1.20			8.2	527	170.40	0.93				
74	57	18.85	1.49	S	37	4	9.7	445	144.00	1.10			
84	50	16.48	1.71	SF	37	4	11	402	130.00	1.22			
90	47	15.45	1.82	SA	37	4	12	354	114.38	1.38	S	67	4
102	41	13.63	2.06	SAF37		4	13	334	108.00	1.46	SF	67	4
115	37	12.08	2.33			15	284	91.96	1.72	SA	67	4	
135	31	10.27	2.74			17	258	83.57	1.89	SAF67		4	
<b>0.75kW</b>						<b>0.75kW</b>							
1.1	4411	1223	0.85			19	224	72.39	2.09				
1.3	3860	1070	0.97			21	234	65.00	2.18				
1.5	3347	928	1.12	S	97R57	4	22	206	63.00	2.37			
1.7	2972	824	1.27	SF	97R57	4	24	195	57.19	2.51			
1.9	2575	714	1.46	SA	97R57	4	26	185	54.00	2.51			
2.2	2258	626	1.67	SAF97R57		4	30	166	45.98	2.95			
2.6	1941	538	1.94			<b>0.75kW</b>							
2.9	1746	484	2.2			13	331	70.04	0.80				
<b>0.75kW</b>						<b>0.75kW</b>							
1.3	2659	1032	0.81			14	369	66.89	0.82	S	57	6	
1.5	2593	930	0.83			15	345	62.53	0.85	SF	57	6	
1.7	2569	831	0.83	S	87R57	4	17	298	54.05	0.95	SA	57	6
1.9	2396	719	0.89	SF	87R57	4	20	253	45.92	1.11	SAF57		6
2.2	2251	624	0.95	SA	87R57	4	22	226	41.00	1.25			
2.5	2013	558	1.06	SAF87R57		4	<b>0.75kW</b>						
3.2	1569	435	1.37			13	334	108.09	0.84				
4.3	1165	323	1.84			15	284	91.84	0.99				
<b>0.75kW</b>						<b>0.75kW</b>							
4.3	1179	327	1.01	S	77R37	4	17	254	82.00	1.11			
4.8	1042	289	1.15	SF	77R37	4	20	217	70.04	1.17			
5.6	902	250	1.32	SA	77R37	4	21	241	66.89	1.25			
6.3	790	219	1.51	SAF77R37		4	22	226	62.53	1.30			
<b>0.75kW</b>						<b>0.75kW</b>							
3.0	1457	230.48	2.58	S	97	8	26	195	54.05	1.45			
3.3	1311	207.48	2.87	SF	97	8	30	166	45.92	1.70	S	57	4
3.6	1187	187.89	3.17	SA	97	8	34	148	41.00	1.91	SF	57	4
<b>0.75kW</b>						<b>0.75kW</b>							
4.1	1048	222.00	2.04	S	87	6	40	126	35.02	2.23	SA	57	4
4.6	935	198.00	2.29	SF	87	6	42	118	32.80	2.27	SAF57		4
5.5	786	166.43	2.73	SA	87	6	46	124	30.12	2.38			
<b>0.75kW</b>						<b>0.75kW</b>							
6.2	690	223.26	3.10	S	87	4	53	108	26.11	2.62			
7.0	612	198.00	3.50	SF	87	4	57	101	24.40	2.80			
8.4	515	166.43	4.16	SA	87	4	66	87	21.09	3.24			
<b>0.75kW</b>						<b>0.75kW</b>							
3.8	1139	241.09	1.05	S	77	6	78	74	17.92	3.82			
4.4	973	206.04	1.23	SF	77	6	87	66	16.00	4.28			
4.8	892	188.89	1.34	SA	77	6	102	56	13.67	5.00			
5.5	783	165.75	1.53	SAF77		6	<b>0.75kW</b>						
<b>0.75kW</b>						<b>0.75kW</b>							
5.8	745	241.09	1.60			31	162	45.00	0.99				
6.7	637	206.04	1.87			36	139	38.44	1.15				
7.4	584	188.89	2.04	S	77	4	39	130	36.00	1.23			
8.4	512	165.75	2.33	SF	77	4	46	109	30.33	1.40	S	47	4
8.8	486	157.08	2.46	SA	77	4	50	114	27.74	1.46	SF	47	4
10	425	137.48	2.81	SAF77		4	54	107	25.93	1.50	SA	47	4
11	383	123.86	3.12			62	92	22.41	1.73	SAF47		4	
13	336	108.65	3.55			73	78	19.04	2.04				
<b>0.75kW</b>						<b>0.75kW</b>							
8.2	527	170.40	0.93			82	70	17.00	2.28				
9.7	445	144.00	1.10			96	60	14.52	2.67				
11	402	130.00	1.22			102	56	13.60	2.85				
12	354	114.38	1.38			121	47	11.46	3.39				
13	334	108.00	1.46			<b>0.75kW</b>							
15	284	91.96	1.72			74	78	18.85	1.09				
17	258	83.57	1.89			84	68	16.48	1.25	S	37	4	
19	224	72.39	2.09			90	64	15.45	1.33	SF	37	4	
21	234	65.00	2.18			102	56	13.63	1.51	SA	37	4	
22	206	63.00	2.37			115	50	12.08	1.71	SAF37		4	
24	195	57.19	2.51			135	42	10.27	2.01				
26	185	54.00	2.51			<b>0.75kW</b>							
30	166	45.98	2.95			13	331	70.04	0.80				
<b>0.75kW</b>						<b>0.75kW</b>							
13	334	108.09	0.84			14	369	66.89	0.82	S	57	6	
15	284	91.84	0.99			15	345	62.53	0.85	SF	57	6	
17	254	82.00	1.11			17	298	54.05	0.95	SA	57	6	
20	217	70.04	1.17			20	253	45.92	1.11	SAF57		6	
21	241	66.89	1.25			22	226	41.00	1.25				
22	226	62.53	1.30			<b>0.75kW</b>							
26	195	54.05	1.45			13	334	108.09	0.84				
30	166	45.92	1.70			15	284	91.84	0.99				
34	148	41.00	1.91			17	254	82.00	1.11				
40	126	35.02	2.23			20	217	70.04	1.17				
42	118	32.80	2.27			21	241	66.89	1.25				
46	124	30.12	2.38			22	226	62.53	1.30				
53	108	26.11	2.62			26	195	54.05	1.45				
57	101	24.40	2.80			30	166	45.92	1.70	S	57	4	
66	87	21.09	3.24			34	148	41.00	1.91	SF	57	4	
78	74	17.92	3.82			40	126	35.02	2.23	SA	57	4	
87	66	16.00	4.28			42	118	32.80	2.27	SAF57		4	
102	56	13.67	5.00			46	124	30.12	2.38				
<b>0.75kW</b>						<b>0.75kW</b>							
31	162	45.00	0.99			53	108	26.11	2.62				
36	139	38.44	1.15			57	101	24.40	2.80				
39	130	36.00	1.23			66	87	21.09	3.24				
46	109	30.33	1.40			78	74	17.92	3.82				
50	114	27.74	1.46			87	66	16.00	4.28				
54	107	25.93	1.50			102	56	13.67	5.00				
62	92	22.41	1.73			<b>0.75kW</b>							
73	78	19.04	2.04			31	162	45.00	0.99				
82	70	17.00	2.28			36	139	38.44	1.15				
96	60	14.52	2.67			39	130	36.00	1.23				
102	56	13.60	2.85			46	109	30.33	1.40	S	47	4	
121	47	11.46	3.39			50	114	27.74	1.46	SF	47	4	
<b>0.75kW</b>						<b>0.75kW</b>							
74	78	18.85	1.09			54	107	25.93	1.50	SA	47	4	
84	68	16.48	1.25	S	37	4	62	92	22.41	1.73	SAF47		4
90	64	15.45	1.33	SF	37	4	73	78	19.04	2.04			
102	56	13.63	1.51	SA	37	4	82	70	17.00	2.28			
115	50	12.08	1.71	SAF37		4	96	60	14.52	2.67			
135	42	10.27	2.01			102	56	13.60	2.85				



输出转速	输出扭矩	传动比	使用系数	机型号	极数	输出转速	输出扭矩	传动比	使用系数	机型号	极数
Output speed	Output torque	Ratio	Service factor	Type	Pole	Output speed	Output torque	Ratio	Service factor	Type	Pole
r/min	Nm	i	f <sub>s</sub>	Type	p	r/min	Nm	i	f <sub>s</sub>	Type	p
<b>1.1kW</b>						<b>1.1kW</b>					
1.7	4328	824	0.87			20	351	70.04	0.80		
2.0	3750	714	1.00	S 97R57	4	21	328	66.89	0.86		
2.2	3288	626	1.14	SF 97R57	4	22	315	62.53	0.89		
2.6	2826	538	1.33	SA 97R57	4	26	284	54.05	0.99		
2.9	2542	484	1.48	SAF97R57	4	30	241	45.92	1.17		
3.3	2206	420	1.70			34	215	41.00	1.31		
						40	184	35.02	1.53	S 57	4
2.2	2547	624	0.84			43	181	32.80	1.56	SF 57	4
2.5	2512	558	0.85			46	172	30.12	1.64	SA 57	4
2.9	2341	485	0.92			54	157	26.11	1.80	SAF57	4
3.2	2285	435	0.94	S 87R57	4	57	146	24.40	1.93		
3.7	1985	378	1.08	SF 87R57	4	66	127	21.09	2.23		
4.3	1697	323	1.26	SA 87R57	4	78	108	17.92	2.62		
5.0	1476	281	1.45	SAF87R57	4	88	96	16.00	2.94		
5.5	1339	255	1.60			102	82	13.67	3.44		
6.3	1166	222	1.84			109	77	12.80	3.67		
6.8	1077	205	1.99			130	65	10.78	4.36		
				S 77R37	4	46	182	30.33	0.88		
6.4	1150	219	1.04	SF 77R37	4	50	167	27.74	0.96		
				SA 77R37	4	54	156	25.93	1.03	S 47	4
				SAF77R37	4	62	135	22.41	1.19	SF 47	4
						74	114	19.04	1.40	SA 47	4
3.0	2136	230.48	1.76	S 97	8	82	102	17.00	1.57	SAF47	4
3.3	1923	207.48	1.96	SF 97	8	96	87	14.52	1.84		
3.6	1742	187.89	2.16	SA 97	8	103	82	13.60	1.96		
				SAF97	8	122	69	11.46	2.33		
				S 97	6	<b>1.5kW</b>					
3.9	1596	230.48	2.36	SF 97	6	2.0	4484	714	0.84		
4.4	1437	207.48	2.62	SA 97	6	2.2	4383	626	0.86	S 97R57	4
4.8	1301	187.89	2.89	SAF97	6	2.6	3853	538	0.98	SF 97R57	4
						2.9	3467	484	1.08	SA 97R57	4
6.3	999	222.00	2.14			3.3	3008	420	1.25	SAF97R57	4
7.1	891	198.00	2.40	S 87	4	3.7	2693	376	1.40		
8.4	749	166.43	2.86	SF 87	4	4.3	2342	327	1.61		
9.2	689	152.95	3.11	SA 87	4						
10.3	612	135.83	3.50	SAF87	4						
						2.9	2707	485	0.79		
5.8	1085	241.09	1.10			3.2	2481	435	0.86		
6.8	928	206.04	1.29			3.7	2313	378	0.93	S 87R57	4
7.4	850	188.89	1.40			4.3	2225	323	0.96	SF 87R57	4
8.4	746	165.75	1.60	S 77	4	5.0	2013	281	1.06	SA 87R57	4
8.9	707	157.08	1.69	SF 77	4	5.5	1826	255	1.17	SAF87R57	4
10	619	137.48	1.93	SA 77	4	6.3	1590	222	1.35		
11	558	123.86	2.14	SAF77	4	6.8	1468	205	1.46		
13	489	108.65	2.44								
15	432	95.88	2.77								
						3.0	2871	230.48	1.31	S 97	8
11	585	130.00	0.84			3.3	2584	207.48	1.45	SF 97	8
12	515	114.38	0.95			3.7	2340	187.89	1.61	SA 97	8
13	486	108.00	1.01			4.1	2076	166.62	1.81	SAF97	8
15	414	91.96	1.18								
17	376	83.57	1.30			4.0	2153	230.48	1.75	S 97	6
19	341	72.39	1.43	S 67	4	4.4	1938	207.48	1.94	SF 97	6
22	326	65.00	1.50	SF 67	4	4.9	1755	187.89	2.14	SA 97	6
23	284	63.00	1.63	SA 67	4	5.5	1557	166.62	2.42	SAF97	6
24	300	57.19	1.72	SAF67	4						
26	284	54.00	1.72			6.1	1415	230.48	2.66	S 97	4
30	242	45.98	2.02			6.7	1274	207.48	2.95	SF 97	4
34	220	41.79	2.23			7.5	1154	187.89	3.26	SA 97	4
39	190	36.20	2.57							SAF97	4
44	165	31.50	2.96								
53	139	26.40	3.53			4.1	2074	222.00	1.03	S 87	6
						4.6	1850	198.00	1.16	SF 87	6
						5.5	1555	166.43	1.38	SA 87	6
						6.1	1429	152.95	1.50	SAF87	6



**选型参数表**  
Selection Table

输出转速	输出扭矩	传动比	使用系数	机型号	极数	输出转速	输出扭矩	传动比	使用系数	机型号	极数
Output speed	Output torque	Ratio	Service factor	Type	Pole	Output speed	Output torque	Ratio	Service factor	Type	Pole
r/min	Nm	i	f <sub>s</sub>	Type	p	r/min	Nm	i	f <sub>s</sub>	Type	p
<b>1.5kW</b>						<b>2.2kW</b>					
6.3	1363	222.00	1.56			3.4	4350	420	0.86	S 97R57	4
7.1	1216	198.00	1.76			3.8	3894	376	0.97	SF 97R57	4
8.4	1022	166.43	2.10	S 87	4	4.3	3387	327	1.11	SA 97R57	4
9.2	939	152.95	2.28	SF 87	4	4.9	2972	287	1.26	SAF97R57	4
10	834	135.83	2.57	SA 87	4	5.6	2610	252	1.44		
12	746	121.44	2.87	SAF87	4						
13	970	109.19	3.20			4.1	3091	230.48	1.22	S 97	6
15	582	94.77	3.68			4.5	2782	207.48	1.35	SF 97	6
						5.0	2520	187.89	1.49	SA 97	6
										SAF97	6
7.4	1160	188.89	1.03			6.2	2046	230.48	1.84		
8.4	1018	165.75	1.17			6.8	1842	207.48	2.04		
8.9	964	157.08	1.24			7.6	1668	187.89	2.25	S 97	4
10	844	137.48	1.41			8.5	1479	166.62	2.54	SF 97	4
11	760	123.86	1.57	S 77	4	9.4	1337	150.64	2.81	SA 97	4
13	667	108.65	1.79	SF 77	4	11	1133	127.68	3.32	SAF97	4
15	589	95.88	2.03	SA 77	4	13	990	111.52	3.80		
16	564	85.00	2.12	SAF77	4	15	863	93.27	4.54		
18	522	78.78	2.29			17	828	83.31	4.36		
19	517	72.22	2.31			6.4	1971	222.00	1.08		
22	454	63.38	2.63			7.2	1758	198.00	1.22		
23	430	60.06	2.78			8.5	1477	166.43	1.45		
27	377	52.57	3.17			9.3	1358	152.95	1.58		
30	339	47.36	3.52			10	1206	135.83	1.78	S 87	4
34	298	41.54	4.01			12	1078	121.44	1.99	SF 87	4
						13	969	109.19	2.21	SA 87	4
17	513	83.57	0.95			15	841	94.77	2.55	SAF87	4
19	466	72.39	1.05			17	753	84.86	2.74		
22	444	65.00	1.10			19	733	75.63	2.84		
23	410	63.00	1.19			20	700	70.40	3.06		
24	387	57.19	1.26			21	630	67.62	3.40		
26	367	54.00	1.26			23	625	60.80	3.43		
30	329	45.98	1.48	S 67	4	27	547	52.77	3.92		
34	299	41.79	1.63	SF 67	4						
39	259	36.20	1.89	SA 67	4	10	1220	137.48	0.98		
44	226	31.50	2.17	SAF67	4	11	1100	123.86	1.09		
53	216	26.40	2.26			13	965	108.65	1.24		
59	195	23.83	2.51			15	851	95.88	1.40		
67	171	20.92	2.86			17	755	85.00	1.46		
71	162	19.80	3.02			18	816	78.78	1.58		
83	138	16.86	3.54			20	748	72.22	1.60		
91	125	15.32	3.90			22	656	63.38	1.82	S 77	4
106	109	13.27	4.50			24	622	60.06	1.92	SF 77	4
121	95	11.55	5.17			27	544	52.57	2.19	SA 77	4
						30	491	47.36	2.43	SAF77	4
43	247	32.80	1.20			34	430	41.54	2.78		
46	235	30.12	1.14			39	380	36.66	3.14		
54	214	26.11	1.32	S 57	4	44	337	32.50	3.55		
57	200	24.40	1.41	SF 57	4	51	307	27.75	3.89		
66	173	21.09	1.63	SA 57	4	55	287	25.93	4.15		
78	147	17.92	1.92	SAF57	4	62	269	22.75	4.43		
88	131	16.00	2.15			66	255	21.56	4.68		
102	112	13.67	2.52								
109	105	12.80	2.69			31	476	45.98	1.03		
130	88	10.78	3.20			34	433	41.79	1.13		
						39	375	36.20	1.30		
96	119	14.52	1.35	S 47	4	45	326	31.50	1.50		
103	111	13.60	1.44	SF 47	4	54	312	26.40	1.56	S 67	4
122	94	11.46	1.71	SA 47	4	60	282	23.83	1.73	SF 67	4
				SAF47	4	68	248	20.97	1.97	SA 67	4
						72	234	19.80	2.09	SAF67	4
						84	200	16.86	2.45		
						93	181	15.32	2.70		
						107	157	13.27	3.11		
						123	137	11.55	3.58		

S



输出转速 Output speed r/min	输出扭矩 Output torque Nm	传动比 Ratio i	使用系数 Service factor f <sub>s</sub>	机型号 Type Type	极数 Pole p	输出转速 Output speed r/min	输出扭矩 Output torque Nm	传动比 Ratio i	使用系数 Service factor f <sub>s</sub>	机型号 Type Type	极数 Pole p
<b>2.2kW</b>						<b>3kW</b>					
89	189	16.00	1.49	S 57	4	39	511	36.20	0.96		
104	162	13.67	1.74	SF 57	4	45	445	31.50	1.10		
111	152	12.80	1.86	SA 57	4	54	426	26.40	1.15		
132	128	10.78	2.21	SAF57	4	60	385	23.83	1.27	S 67	4
<b>3kW</b>						68	338	20.97	1.44	SF 67	4
4.9	4053	287	0.93	S 97R57	4	72	320	19.80	1.53	SA 67	4
				SF 97R57	4	84	272	16.86	1.80	SAF67	4
				SA 97R57	4	93	247	15.32	1.98		
				SAF97R57	4	107	214	13.27	2.28		
						123	186	11.55	2.62		
6.2	2790	230.48	1.35			104	221	13.67	1.28	S 57	4
6.8	2512	207.48	1.50			111	207	12.80	1.36	SF 57	4
7.6	2275	187.89	1.65			132	174	10.78	1.62	SA 57	4
8.5	2017	166.62	1.86	S 97	4					SAF57	4
9.4	1824	150.64	2.06	SF 97	4	<b>4kW</b>					
11	1546	127.68	2.43	SA 97	4	6.2	3668	230.48	1.02		
13	1350	111.52	2.79	SAF97	4	6.9	3302	207.48	1.14		
15	1129	93.27	3.20			7.7	2991	187.89	1.26		
17	1177	83.31	3.33			8.6	2652	166.62	1.42		
18	978	80.75	3.85			9.6	2398	150.64	1.57	S 97	4
<b>3kW</b>						11	2032	127.68	1.85	SF 97	4
8.5	2015	166.43	1.06			13	1775	111.52	2.12	SA 97	4
9.3	1852	152.95	1.16			15	1547	93.27	2.43	SAF97	4
10	1644	135.83	1.30			17	1485	83.31	2.53		
12	1470	121.44	1.46			18	1399	80.75	2.93		
13	1322	109.19	1.62			19	1285	75.32	2.69		
15	1147	94.77	1.87	S 87	4	23	1185	63.84	3.17		
17	1027	84.86	2.01	SF 87	4	26	1035	55.76	3.63		
19	1068	75.63	2.09	SA 87	4	<b>4kW</b>					
20	955	70.40	2.24	SAF87	4	12	1933	121.44	1.11		
21	859	67.62	2.50			13	1738	109.19	1.23		
23	852	60.80	2.51			15	1508	94.77	1.42		
27	745	52.77	2.88			17	1404	84.86	1.53		
30	696	47.25	3.08			19	1351	75.63	1.59		
33	667	43.13	3.21			20	1256	70.40	1.71		
36	617	39.20	3.47			21	1129	67.62	1.90		
37	554	38.25	3.87			24	1121	60.80	1.91	S 87	4
42	481	34.09	4.45			27	980	52.77	2.19	SF 87	4
<b>3kW</b>						30	915	47.25	2.34	SA 87	4
17	1113	85.00	1.07			33	877	43.13	2.44	SAF87	4
18	1029	78.78	1.16			37	812	39.20	2.64		
20	1020	72.22	1.17			38	728	38.25	2.94		
22	895	63.38	1.33			42	682	34.09	3.14		
24	848	60.06	1.41			45	633	32.15	3.39		
27	742	52.57	1.61			49	627	29.55	3.42		
30	669	47.36	1.79			55	557	26.24	3.85		
34	587	41.54	2.04	S 77	4	61	498	23.46	4.30		
39	518	36.66	2.31	SF 77	4	<b>4kW</b>					
44	459	32.50	2.60	SA 77	4	24	1115	60.06	1.07		
51	419	27.75	2.85	SAF77	4	27	976	52.57	1.22		
55	392	25.93	3.05			30	879	47.36	1.36		
62	367	22.75	3.25			35	771	41.54	1.55		
66	348	21.56	3.43			39	681	36.66	1.75		
75	305	18.87	3.92			44	604	32.50	1.98	S 77	4
84	274	17.00	4.35			52	550	27.75	2.17	SF 77	4
95	241	14.91	4.96			56	515	25.93	2.32	SA 77	4
108	212	13.16	5.62			63	483	22.75	2.47	SAF77	4
122	188	11.67	6.34			67	458	21.56	2.61		
143	161	9.96	7.43			76	400	18.87	2.98		
<b>3kW</b>						85	361	17.00	3.31		
						97	316	14.91	3.77		
						109	279	13.16	4.28		
						123	248	11.67	4.82		
						145	211	9.96	5.65		



选型参数表  
Selection Table

输出转速 Output speed r/min	输出扭矩 Output torque Nm	传动比 Ratio i	使用系数 Service factor f <sub>s</sub>	机型号 Type Type	极数 Pole p	输出转速 Output speed r/min	输出扭矩 Output torque Nm	传动比 Ratio i	使用系数 Service factor f <sub>s</sub>	机型号 Type Type	极数 Pole p
<b>4kW</b>						<b>7.5kW</b>					
73	420	19.80	1.16			13	3304	111.52	1.14		
85	358	16.86	1.37	S 67	4	16	2880	93.27	1.31		
94	325	15.32	1.50	SF 67	4	17	2764	83.31	1.36		
109	282	13.27	1.74	SA 67	4	18	2604	80.75	1.44		
125	245	11.55	1.99	SAF67	4	19	2393	75.32	1.57		
<b>5.5kW</b>						<b>11kW</b>					
8.6	3647	166.62	1.03			23	2207	63.84	1.70		
9.6	3297	150.64	1.14			26	1928	55.76	1.95	S 97	4
11	2794	127.68	1.35			31	1612	46.64	2.33	SF 97	4
13	2441	111.52	1.54			36	1438	40.38	2.62	SA 97	4
15	2127	93.27	1.77	S 97	4	40	1396	36.39	2.69	SAF97	4
17	2041	83.31	1.84	SF 97	4	45	1294	32.76	2.91		
18	1923	80.75	1.96	SA 97	4	49	1172	29.67	3.21		
19	1767	75.32	2.13	SAF97	4	55	1039	26.31	3.62		
23	1630	63.84	2.31			61	940	23.79	4.00		
26	1424	55.76	2.64			72	796	20.16	4.72		
31	1191	46.64	3.16			<b>15kW</b>					
36	1031	40.38	3.65			31	1704	47.25	1.26		
<b>7.5kW</b>						34	1633	43.13	1.31		
17	1931	84.86	1.11			37	1511	39.20	1.42		
19	1857	75.63	1.15			38	1355	38.25	1.58		
20	1727	70.40	1.24			43	1270	34.09	1.69		
21	1552	67.62	1.38			45	1178	32.15	1.82	S 87	4
24	1541	60.80	1.39			49	1167	29.55	1.84	SF 87	4
27	1347	52.77	1.59			56	1037	26.24	2.07	SA 87	4
30	1259	47.25	1.70			62	927	23.46	2.31	SAF87	4
33	1206	43.13	1.78	S 87	4	69	833	21.09	2.57		
37	1116	39.20	1.92	SF 87	4	80	723	18.31	2.96		
38	1001	38.25	2.14	SA 87	4	89	648	16.39	3.31		
42	938	34.09	2.28	SAF87	4	107	537	13.60	3.99		
45	870	32.15	2.46			123	467	11.83	4.59		
49	862	29.55	2.49			<b>15kW</b>					
55	766	26.24	2.80			53	1024	27.75	1.17		
61	685	23.46	3.13			56	959	25.93	1.24		
68	615	21.09	3.48			64	899	22.75	1.33	S 77	4
79	534	18.31	4.01			68	852	21.56	1.40	SF 77	4
88	478	16.39	4.48			77	746	18.87	1.60	SA 77	4
106	397	13.60	5.40			86	672	17.00	1.78	SAF77	4
122	345	11.83	6.21			98	589	14.91	2.03		
<b>4kW</b>						111	520	13.16	2.30		
35	1061	41.54	1.13			125	461	11.67	2.59		
39	936	36.66	1.28			147	394	9.96	3.03		
44	830	32.50	1.44			<b>11kW</b>					
52	757	27.75	1.58			26	2808	55.76	1.34		
56	709	25.93	1.69	S 77	4	31	2349	46.64	1.60		
63	664	22.75	1.80	SF 77	4	36	2095	40.38	1.80		
67	629	21.56	1.90	SA 77	4	40	2034	36.39	1.85	S 97	4
76	551	18.87	2.17	SAF77	4	45	1886	32.76	1.99	SF 97	4
85	496	17.00	2.41			49	1708	29.67	2.20	SA 97	4
97	435	14.91	2.74			55	1514	26.31	2.48	SAF97	4
109	384	13.16	3.11			61	1369	23.79	2.75		
123	341	11.67	3.51			72	1160	20.16	3.24		
145	291	9.96	4.11			83	1014	17.61	3.71		
<b>5.5kW</b>						99	848	14.73	4.43		
94	447	15.32	1.09	S 67	4	115	734	12.75	5.12		
109	387	13.27	1.26	SF 67	4	<b>15kW</b>					
125	337	11.55	1.45	SA 67	4	56	1510	26.24	1.42		
<b>7.5kW</b>						62	1350	23.46	1.59	S 87	4
17	1931	84.86	1.11			69	1214	21.09	1.77	SF 87	4
19	1857	75.63	1.15			80	1054	18.31	2.03	SA 87	4
20	1727	70.40	1.24			89	943	16.39	2.27	SAF87	4
21	1552	67.62	1.38			107	783	13.60	2.74		
24	1541	60.80	1.39			123	681	11.83	3.15		
27	1347	52.77	1.59			<b>15kW</b>					
30	1259	47.25	1.70			56	1510	26.24	1.42		
33	1206	43.13	1.78	S 87	4	62	1350	23.46	1.59	S 87	4
37	1116	39.20	1.92	SF 87	4	69	1214	21.09	1.77	SF 87	4
38	1001	38.25	2.14	SA 87	4	80	1054	18.31	2.03	SA 87	4
42	938	34.09	2.28	SAF87	4	89	943	16.39	2.27	SAF87	4
45	870	32.15	2.46			107	783	13.60	2.74		
49	862	29.55	2.49			123	681	11.83	3.15		
55	766	26.24	2.80			<b>15kW</b>					
61	685	23.46	3.13			56	1510	26.24	1.42		
68	615	21.09	3.48			62	1350	23.46	1.59	S 87	4
79	534	18.31	4.01			69	1214	21.09	1.77	SF 87	4
88	478	16.39	4.48			80	1054	18.31	2.03	SA 87	4
106	397	13.60	5.40			89	943	16.39	2.27	SAF87	4
122	345	11.83	6.21			107	783	13.60	2.74		
<b>4kW</b>						123	681	11.83	3.15		
35	1061	41.54	1.13			<b>15kW</b>					
39	936	36.66	1.28			56	1510	26.24	1.42		
44	830	32.50	1.44			62	1350	23.46	1.59	S 87	4
52	757	27.75	1.58			69	1214	21.09	1.77	SF 87	4
56	709	25.93	1.69	S 77	4	80	1054	18.31	2.03	SA 87	4
63	664	22.75	1.80	SF 77	4	89	943	16.39	2.27	SAF87	4
67	629	21.56	1.90	SA 77	4	107	783	13.60	2.74		
76	551	18.87	2.17	SAF77	4	123	681	11.83	3.15		
85	496	17.00	2.41			<b>15kW</b>					
97	435	14.91	2.74			56	1510	26.24	1.42		
109	384	13.16	3.11			62	1350	23.46	1.59	S 87	4
123	341	11.67	3.51			69	1214	21.09	1.77	SF 87	4
145	291	9.96	4.11			80	1054	18.31	2.03	SA 87	4
<b>5.5kW</b>						89	943	16.39	2.27	SAF87	4
94	447	15.32	1.09	S 67	4	107	783	13.60	2.74		
109	387	13.27	1.26	SF 67	4	123	681	11.83	3.15		
125	337	11.55	1.45	SA 67	4	<b>15kW</b>					
<b>7.5kW</b>						56	1510	26.24	1.42		
17	1931	84.86	1.11			62	1350	23.46	1.59	S 87	4
19	1857	75.63	1.15			69	1214	21.09	1.77	SF 87	4
20	1727	70.40	1.24			80	1054	18.31	2.03	SA 87	4
21	1552	67.62	1.38			89	943	16.39	2.27	SAF87	4
24	1541	60.80	1.39			107	783	13.60	2.74		
27	1347	52.77	1.59			123	681	11.83	3.15		
30	1259	47.25	1.70			<b>15kW</b>					
33	1206	43.13	1.78	S 87	4	56	1510	26.24	1.42		
37	1116	39.20	1.92	SF 87	4	62	1350	23.46	1.59	S 87	4
38	1001	38.25	2.14	SA 87	4	69	1214	21.09	1.77	SF 87	4
42	938	34.09	2.28	SAF87	4	80	1054	18.31	2.03	SA 87	4
45	870	32.15	2.46			89	943	16.39	2.27	SAF87	4
49	862	29.55	2.49			107	783	13.60	2.74		
55	766	26.24	2.80			123	681	11.83	3.15		
61	685	23.46	3.13			<b>15kW</b>					
68	615	21.09	3.48			56	1510	26.24	1.42		
79	534	18.31	4.01			62	1350	23.46	1.59	S 87	4
88	478	16.39	4.48			69	1214	21.09	1.77	SF 87	4
106	397	13.60	5.40			80	1054	18.31	2.03	SA 87	4
122	345	11.83	6.21			89	943	16.39	2.27	SAF87	4
<b>4kW</b>						107	783	13.60	2.74		
35	1061	41.54	1.13			123	681	11.83	3.15		
39	936	36.66	1.28			<b>15kW</b>					
44	830	32.50	1.44			56	1510	26.24	1.42		
52	757	27.75	1.58			62	1350	23.46	1.59	S 87	4
56	709	25.93	1.69	S 77	4	69	1214	21.09	1.77	SF 87	4
63	664	22.75	1.80	SF 77	4	80	1054	18.31	2.03	SA 87	4
67	629	21.56	1.90	SA 77	4	89	943	16.39	2.27	SAF87	4
76	551	18.87	2.17	SAF77	4	107	783	13.60	2.74		
85	496	17.00	2.41			123	681	11.83	3.15		
97	435	14.91	2.74								



输出转速	输出扭矩	传动比	使用系数	机型号	极数	输出转速	输出扭矩	传动比	使用系数	机型号	极数
Output speed	Output torque	Ratio	Service factor	Type	Pole	Output speed	Output torque	Ratio	Service factor	Type	Pole
r/min	Nm	i	f <sub>s</sub>	Type	p	r/min	Nm	i	f <sub>s</sub>	Type	p
<b>15kW</b>											
31	3203	46.64	1.17								
36	2856	40.38	1.32								
40	2773	36.39	1.36								
45	2571	32.76	1.46								
49	2329	29.67	1.61	S 97	4						
55	2065	26.31	1.82	SF 97	4						
61	1867	23.79	2.01	SA 97	4						
72	1582	20.16	2.38	SAF97	4						
83	1382	17.61	2.72								
99	1156	14.73	3.25								
115	1001	12.75	3.76								
89	1287	16.39	1.67	S 87	4						
107	1068	13.60	2.01	SF 87	4						
123	929	11.83	2.31	SA 87	4						
				SAF87	4						
<b>18.5kW</b>											
40	3499	36.39	1.07								
45	3150	32.76	1.19								
50	2853	29.67	1.32								
56	2530	26.31	1.49	S 97	4						
62	2287	23.79	1.64	SF 97	4						
73	1938	20.16	1.94	SA 97	4						
83	1693	17.61	2.22	SAF97	4						
100	1416	14.73	2.65								
115	1226	12.75	3.07								
<b>22kW</b>											
56	3008	26.31	1.25								
62	2720	23.79	1.38								
73	2305	20.16	1.63	S 97	4						
83	2014	17.61	1.87	SF 97	4						
100	1684	14.73	2.23	SA 97	4						
115	1458	12.75	2.58	SAF97	4						

S



**选型参数表**  
Selection Table

Mamax Permissible torque Nm	输出转速 Output speed r/min	传动比 Ratio i	机 型 号 Type Type	功率 Power kW/4p	Mamax Permissible torque Nm	输出转速 Output speed r/min	传动比 Ratio i	机 型 号 Type Type	功率 Power kW/4p
90	7.8	179	S 37R17 SF 37R17 SA 37R17 SAF37R17	0.18	2280	0.24	5875	S 87R57 SF 87R57 SA 87R57 SAF87R57	0.18
	8.8	158				0.27	5187		
	9.7	144				0.30	4606		
	12	118				0.36	3872		
13	110	0.40	3475	0.25					
170	3.6	388	S 47R17 SF 47R17 SA 47R17 SAF47R17	0.18		0.48	2905		0.37
	4.1	336				0.54	2586		
	4.7	294				0.60	2335		
	5.4	257				0.68	2054		
	6.1	229				0.76	1824		
	7.0	200			0.85	1631			
	7.4	187			1.0	1332			
	8.4	165			1.2	1191			
300	2.4	574	S 57R17 SF 57R17 SA 57R17 SAF57R17	0.18	1.3	1032	1.1		
	2.7	506			1.5	930			
	3.2	438			1.7	831			
	3.6	388			1.9	719			
	4.1	336			2.2	624			
	4.7	294			2.5	558			
	5.2	269			2.9	485			
	6.1	229			3.2	435			
	6.8	204			3.7	378			
	7.4	187			4.4	323			
	8.4	165			5.1	281			
	11	131			0.18	0.16		8608	
520	1.3	1045	S 67R37 SF 67R37 SA 67R37 SAF67R37	0.18	0.18	7554	0.18		
	1.5	914			0.21	6640			
	1.7	809			0.24	5780			
	2.0	712			0.28	4937			
	2.3	615			0.31	4444			
	2.6	543			0.35	4017			
	3.0	469			0.40	3453			
	3.3	424			0.45	3108			
	3.8	365			0.52	2654			
	4.4	319			0.60	2329			
1270	4.9	281	S 77R37 SF 77R37 SA 77R37 SAF77R37	0.55	4000	0.67	2081	S 97R57 SF 97R57 SA 97R57 SAF97R57	0.55
	5.7	246				0.75	1860		
	6.3	221				0.88	1574		
	7.0	198				1.0	1394		
	0.45	3098				1.1	1223		
	0.67	2083				1.3	1070		
	0.77	1813				1.5	928		
	0.80	1745				1.7	824		
	0.87	1600				2.0	714		
	1.0	1404				2.2	626		
	1.1	1245			2.6	538			
	1.3	1100			2.9	484			
	1.5	954			3.4	420			
	1.7	837			3.8	376			
1.9	714	4.3	327						
2.2	637	4.9	287						
2.4	574	5.7	252						
2.8	499	6.6	219						
3.2	438	0.75	0.75	1600					
3.6	389	0.55	0.55	1270					
4.3	327	0.37	0.37	970					
4.8	289	0.25	0.25	770					
5.6	250	0.18	0.18	520					
6.4	219	0.11	0.11	370					

表上所配功率均有超载,按实际条件确定的转矩不得大于减速机额定转矩。

The power are all overload in the table. The decided torque according to operating condition should not more than gear units' nominal torque.



SF37/φ120

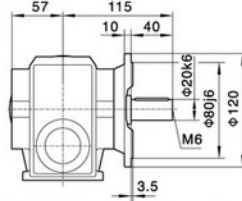
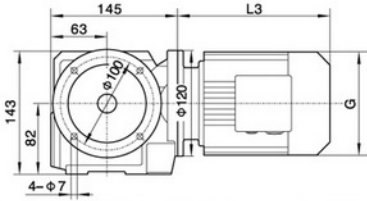

SAF37/φ120

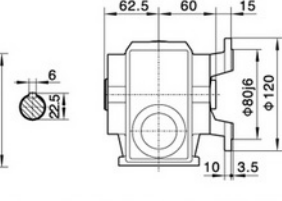

SF37/φ160

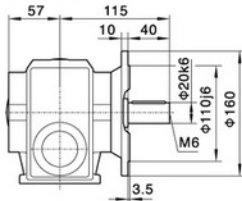

SAF37/φ160

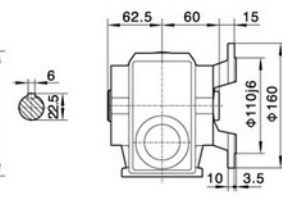

SA37

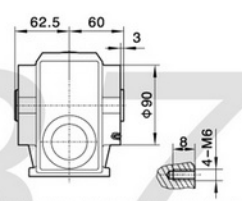
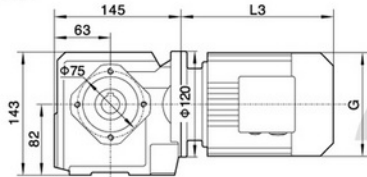

SAF37/SA37/SAZ37  
空心轴/Hollow shaft

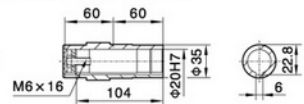

S37

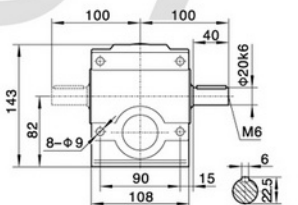
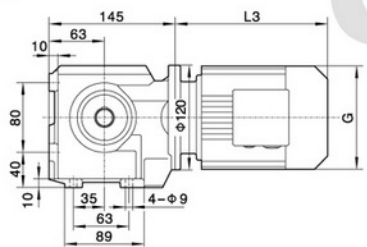

S..37R17

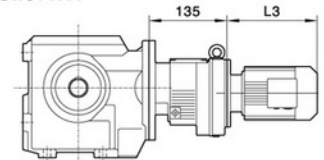

S..S37

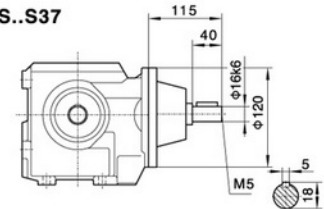

SAT37

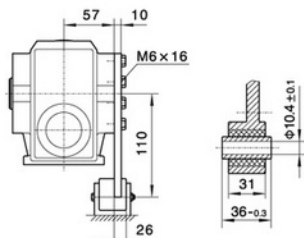
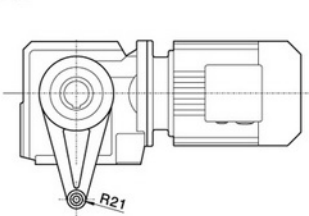

电机需方配或配特殊电机时需加联接法兰  
When equipping the user's motor or the special one, the flange is required to be connected.

注: 其余尺寸见相对应结构形式  
Note: For other values please refer to the opposed structure.

Y2电机座号 Motor size	63	71	80		
功率/4P Power/(kW)	0.18	0.25	0.37	0.55	0.75
L3	235	245	278		
G	130	145	175		
L2	71	71	71		

注: 1.SA, SF, SAF, SAZ壳体为通用件, 安装尺寸均可相互参照。2."S.."表示S, SA, SF, SAF, SAZ

Note: 1.The housings of SA, SF, SAF, SAZ are common parts. The mounting dimensions may consult each other. 2."S.."mean S, SA, SF, SAF, SAZ



# 外形安装尺寸 Mounting Dimension Sheets-overview

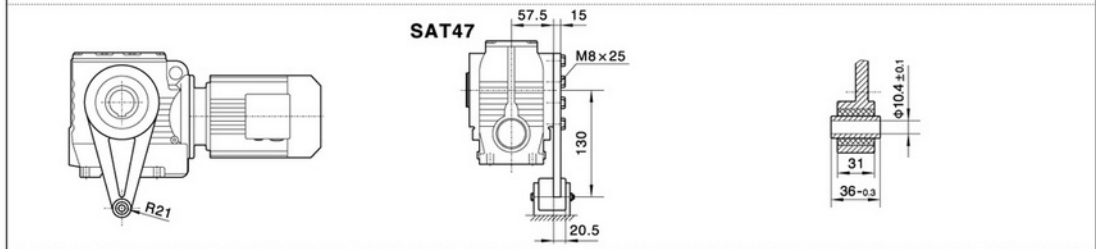
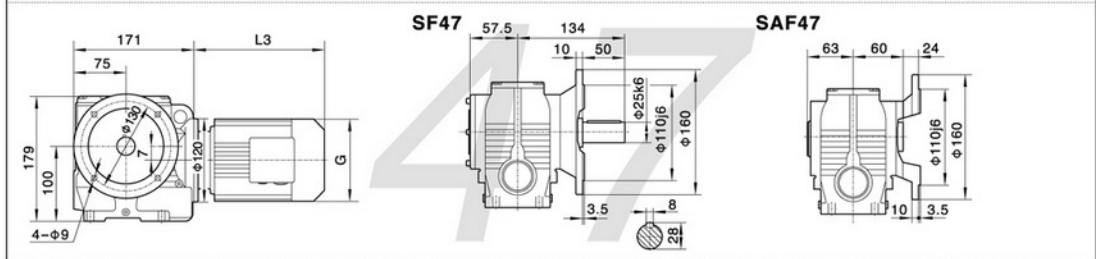
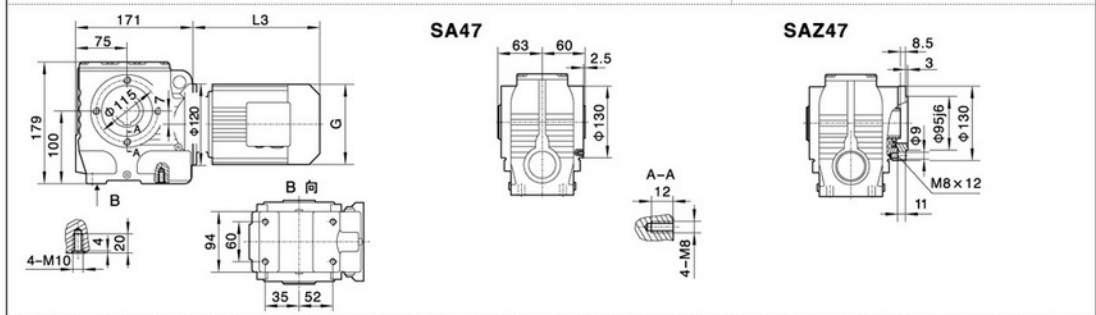
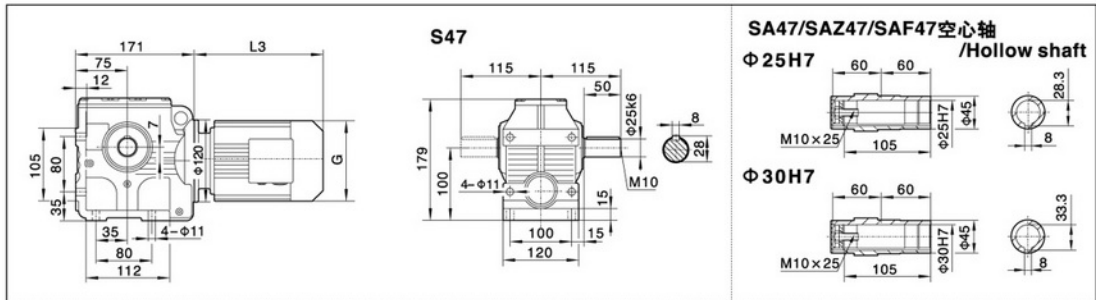

电机需方配或配特殊电机时需加联接法兰

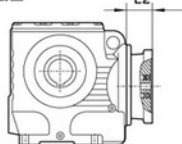

S..S47

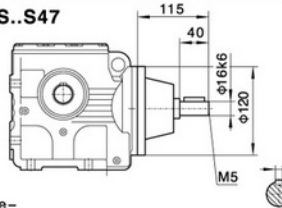

S..47R17

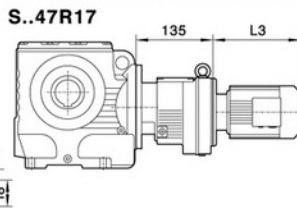

注：其余尺寸见相对应结构形式  
Note: For other values please refer to the opposed structure.

When equipping the user's motor or the special one, the flange is required to be connected.

Y2电机座号 Motor size	63	71	80	90S	90L			
功率/4P Power/(kW)	0.18	0.25 0.37	0.55 0.75	1.1	1.5			
L3	235	245	278	304	328			
G	130	145	175	195	195			
L2	71	71	71	71	71			

注:1.SA、SF、SAF、SAZ壳体为通用件,安装尺寸均可相互参照.2."S.."表示S、SA、SF、SAF、SAZ

Note:1.The housings of SA, SF, SAF, SAZ are common parts.The mounting dimensions may consult each other. 2."S.."mean S, SA, SF, SAF, SAZ

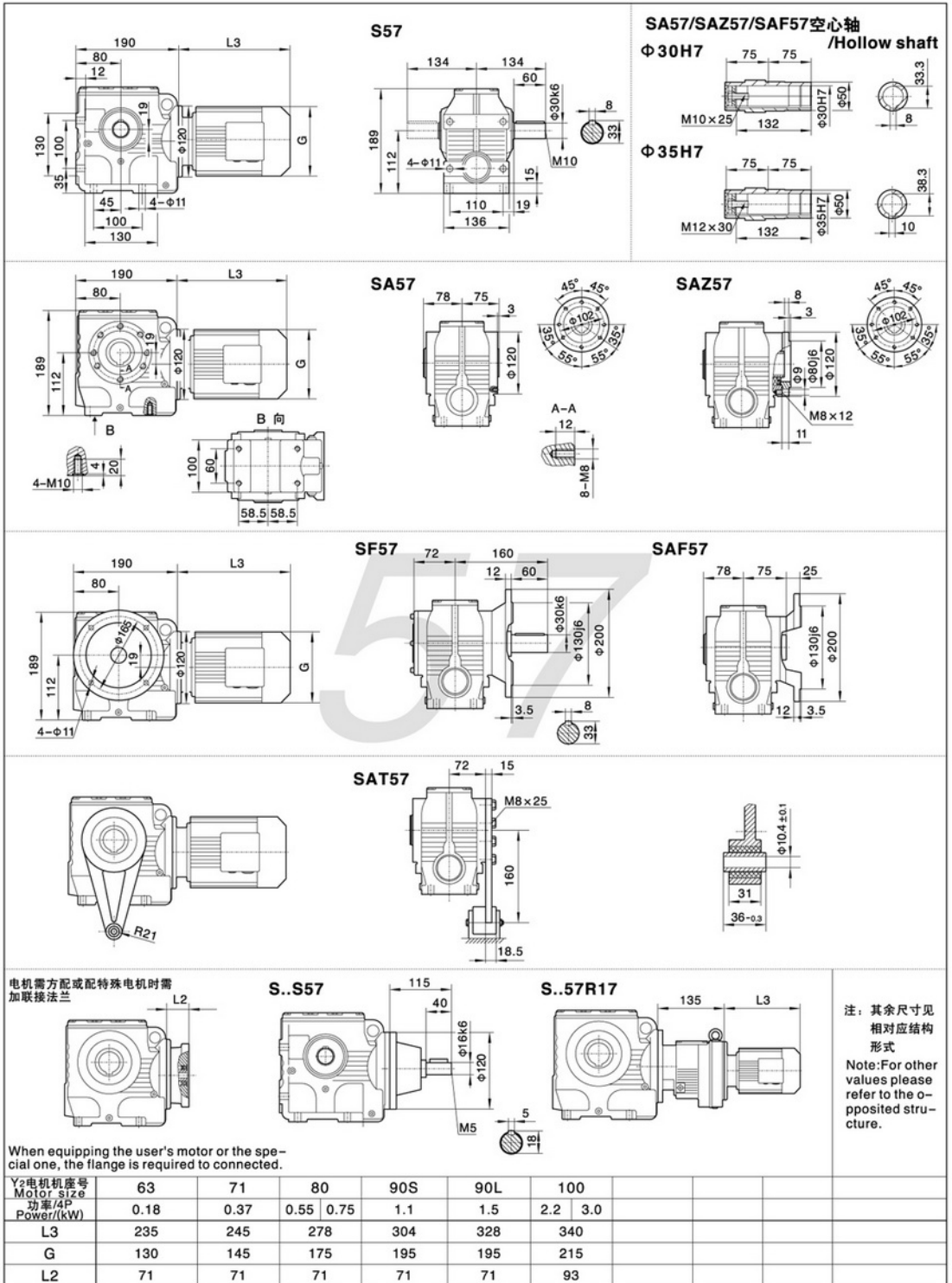

电机需方配或配特殊电机时需加联接法兰



When equipping the user's motor or the special one, the flange is required to be connected.

Y2电机型号 Motor size	63	71	80	90S	90L	100				
功率/4P Power/(kW)	0.18	0.37	0.55 0.75	1.1	1.5	2.2 3.0				
L3	235	245	278	304	328	340				
G	130	145	175	195	195	215				
L2	71	71	71	71	71	93				

注：1.SA、SF、SAF、SAZ壳体为通用件,安装尺寸均可相互参照。2."S.."表示S、SA、SF、SAF、SAZ

Note:1.The housings of SA、SF、SAF、SAZ are common parts.The mounting dimensions may consult each other. 2."S.."mean S、SA、SF、SAF、SAZ



# 外形安装尺寸 Mounting Dimension Sheets-overview

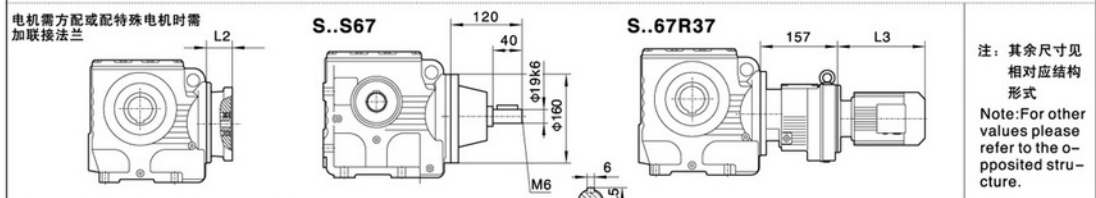
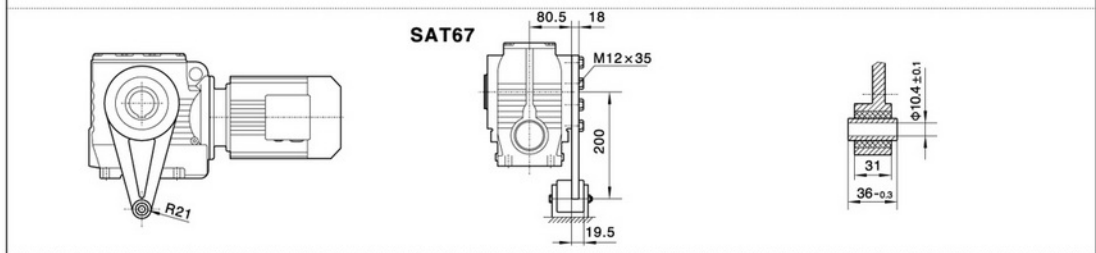
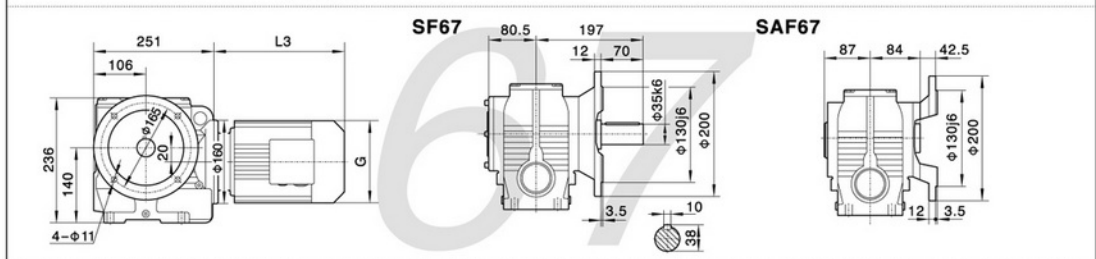
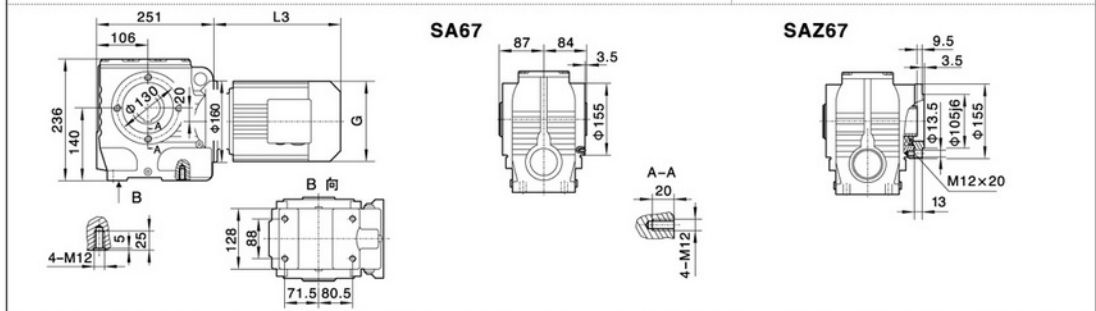
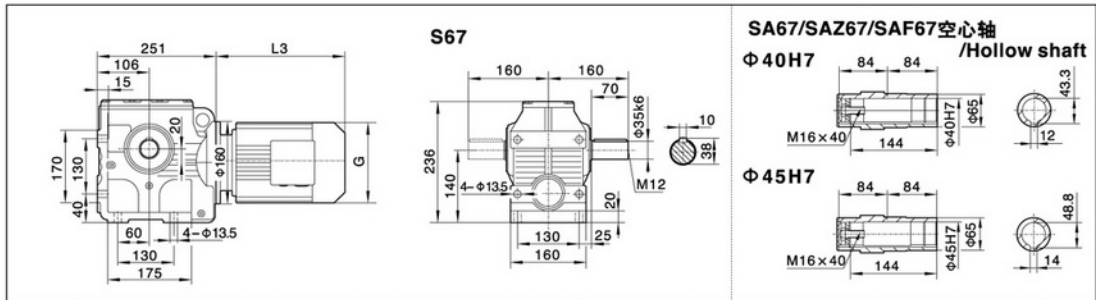

注：其余尺寸见  
相对应结构  
形式  
Note: For other  
values please  
refer to the o-  
poseded stru-  
cture.

电机需方配或配特殊电机时需  
加联接法兰

When equipping the user's motor or the special one, the flange is required to be connected.

Y2电机座号 Motor size	71	80	90S	90L	100	112M	132S					
功率/4P Power/(kW)	0.25	0.37	0.55	0.75	1.1	1.5	2.2	3.0	4.0	5.5		
L3	245	278	304	328	350	380	425					
G	145	175	195	195	215	240	275					
L2	81	81	81	81	93	93	101					

注:1.SA、SF、SAF、SAZ壳体为通用件,安装尺寸均可相互参照.2."S.."表示S、SA、SF、SAF、SAZ  
Note:1.The housings of SA、SF、SAF、SAZ are common parts.The mounting dimensions may consult each other. 2."S.."mean S、SA、SF、SAF、SAZ

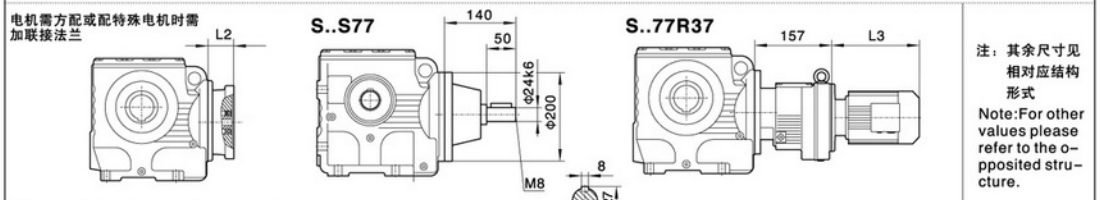
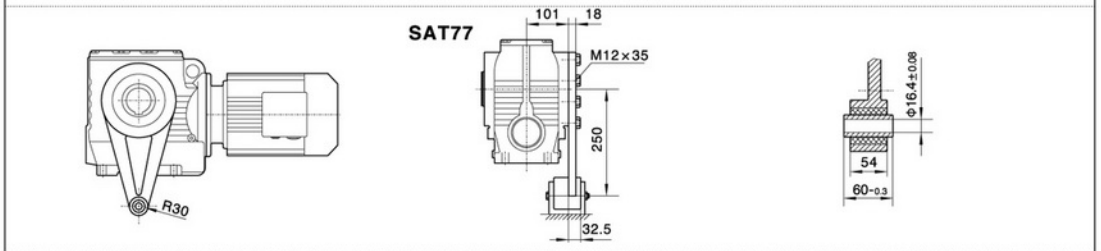
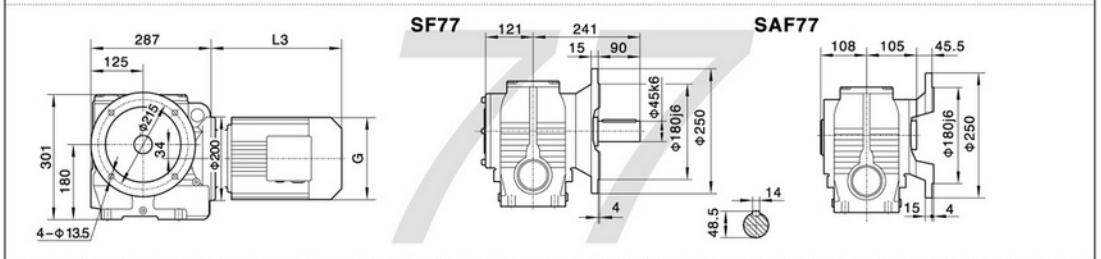
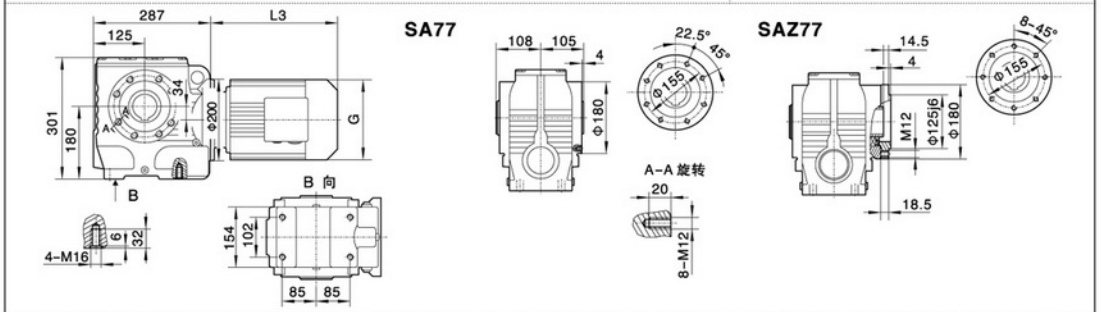
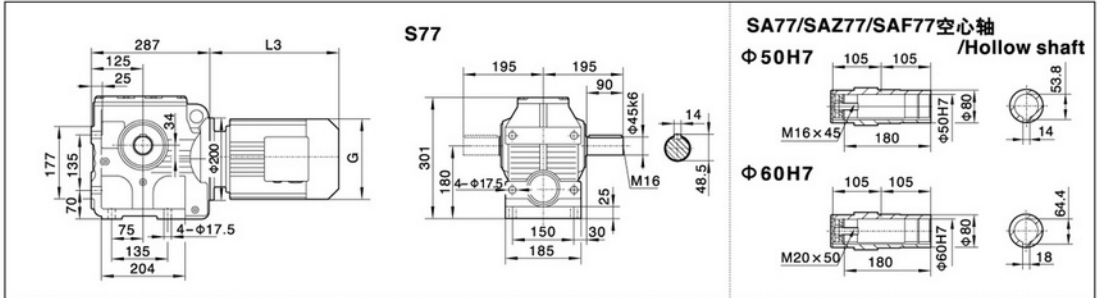

电机需方配或配特殊电机时需加联接法兰

When equipping the user's motor or the special one, the flange is required to be connected.

Y2电机机座号 Motor size	80	90S	90L	100	112M	132S	132M		
功率/4P Power/(kW)	0.55	0.75	1.1	1.5	2.2	3.0	4.0	5.5	7.5
L3	278	304	328	350	380	425	461		
G	175	195	195	215	240	275	275		
L2	81	81	81	93	93	101	101		

注:1.SA, SF, SAF, SAZ壳体为通用件,安装尺寸均可相互参照.2."S.."表示S, SA, SF, SAF, SAZ  
Note:1.The housings of SA, SF, SAF, SAZ are common parts.The mounting dimensions may consult each other. 2."S.."mean S, SA, SF, SAF, SAZ



# 外形安装尺寸 Mounting Dimension Sheets-overview

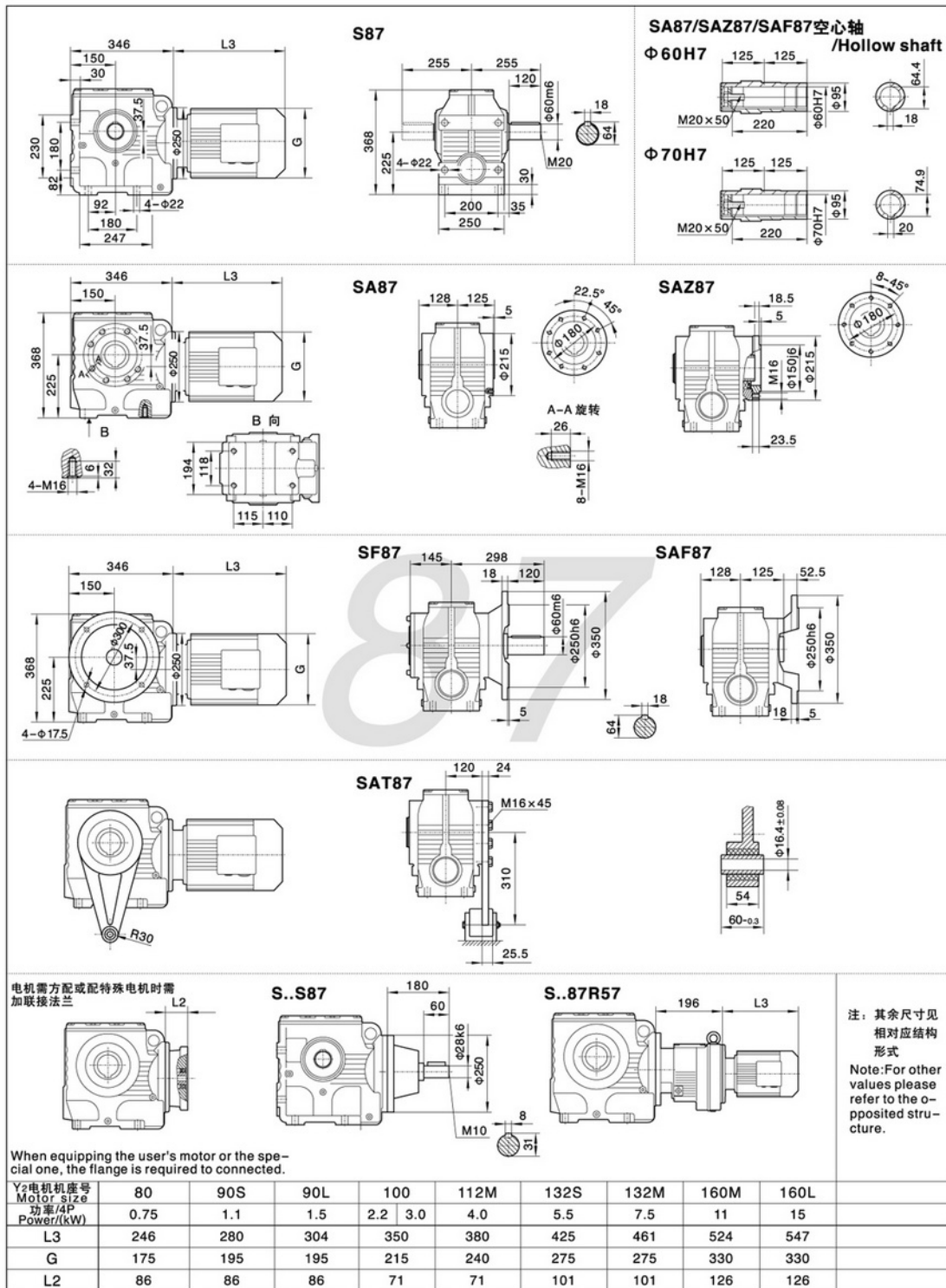

S

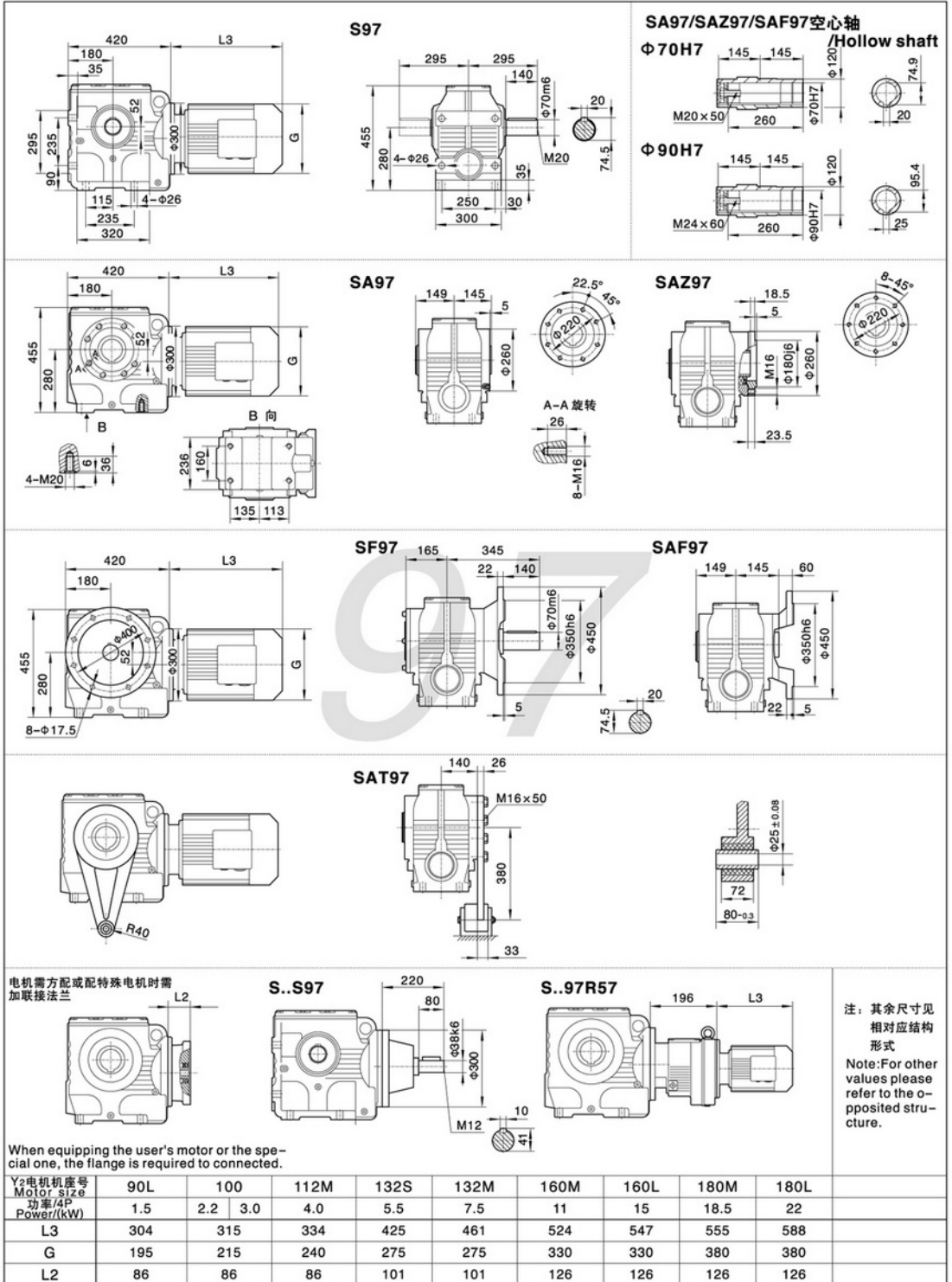

S